

Negator Cassette

Simplify maintenance and improve the performance of your Varec 2500 ATG

Varec®

The Varec Model 2500 Automatic Tank Gauge (ATG) has been the industry standard in mechanical automatic tank gauging for over 50 years. Key to the operation of mechanical float and tape operated tank gauges, the negator motor provides the constant pullback tension required for the float to follow the liquid level as it rises and falls. Installation and replacement of the negator motor can be a difficult and time consuming process.

With that in mind, we offer you a removable cassette with the negator motor enclosed. This simplifies the process of negator motor replacement and improves the performance of your mechanical tank gauge.

Enhanced gauge function and reliability

- Self aligning, ensuring tracking of gauge tape and motor
- Eliminates contaminants in the spring motor

Reduced maintenance

- Allows for easier and quicker installation with no tape to pull out or negator hubs to unwind

Extended function life

- Protects from pipe debris being wound up in the motor that could cause stretching or corrosion

Increased safety

- Enclosed negator motor will not unwind in your hands during installation

Complete compatibility

- Fits all aluminum Varec 2500 Model B Tank Gauges



Also introducing the Varec 2900 Float & Tape Transmitter (FTT)

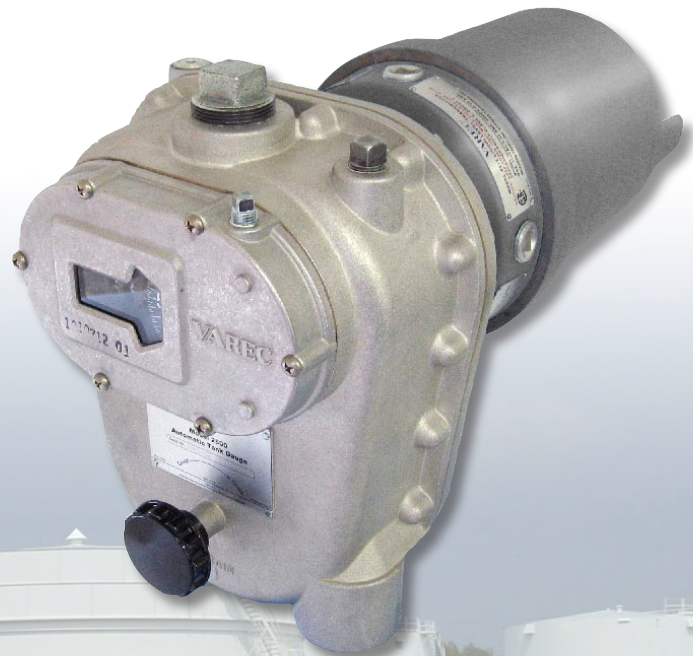

The 2900 Float & Tape Transmitter (FTT) is Varec's latest precision absolute optical encoder (Patent Pending).

www.TankGauging.com

Negator Cassette Ordering Information

Ordering information

- 13-10652 Cassette Motor Kit (for negator motor to cassette conversion)
- 06-10368 Cassette Assembly only

This kit provides all the parts (Highlighted *) required for converting a 2500 Automatic Tank Gaugehead fitted with a negator motor to a gaugehead with a negator cassette.

Note! Use items 44 and 45 as required

Item #	Description
4	Teflon Washer (x2) Not shown - used on older gaugeheads
23	Retaining Ring, 5/16 SS (x1)
44	Washer 9/16X21/64X1/16 SS (x1)
45	Shim washer 562X.316/.313X.005SS (x6)
49	HSCS 1/4-20X1-1/4 (x2)
50	Negator Cassette (x1)
51	Tape Storage Sheave Assembly (x1)
52	Crank Handle (x1)

Standard Gaugehead

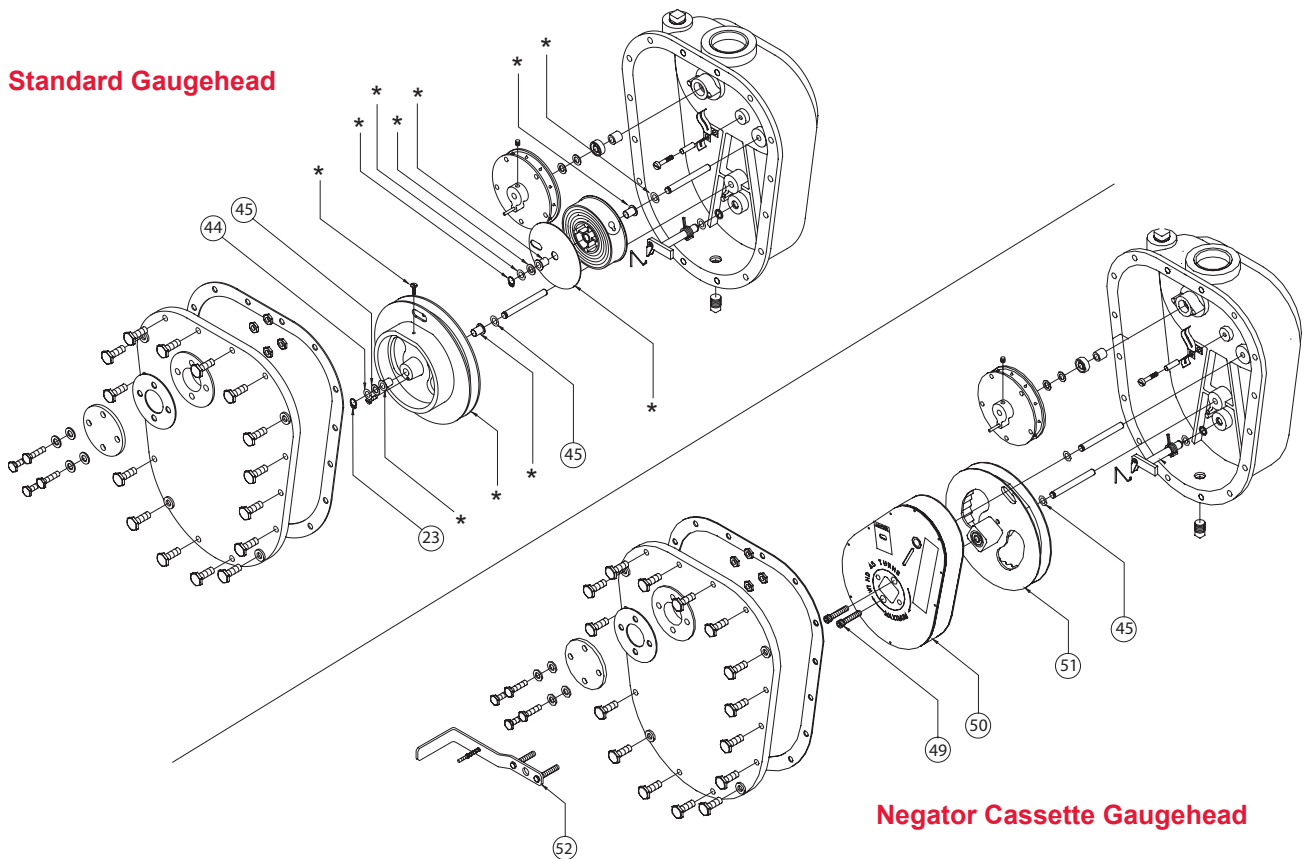

Negator Cassette Gaugehead

Corporate Headquarters
5834 Peachtree Corners East
Norcross, GA 30092
Tel: +1 (770) 447-9202
Toll Free: +1 (866) 698-2732
Fax: +1 (770) 662-8939

North American Sales
9801 Westheimer, Suite 302
Houston, TX 77042
Tel: +1 (281) 498-9202
Fax: +1 (281) 498-0183

Defense and Government Services
1800 Diagonal Road, Suite 600
Alexandria, VA 22314
Tel: +1 (703) 837-9202
Fax: +1 (703) 837-9209

Varec[®]

www.varec.com